



Capacitive sensors Series - KXS-Extreme

Housing M 30 x 1.5

- Housing material: Stainless steel VA No. 1.4305
- For connection to capacitive evaluation units KXA-...
- Extreme large sensing distance
- Up to 250° C ambient temperature

Certificate:



Technical data

Operating distance S_n	60 mm
Operating distance min / max adjustable	5...100 mm
Mounting	Flush / non-flush
Type	KXS-M30/70
Art.-No.	498 004
Permitted ambient temperature	-70...+250 °C
Enclosure rating IEC 60529*	IP 67
Norm	EN 60947-5-2
Connection cable for connection to capacitive evaluation units KXA-... with plug-in connector	2 m FEP, Triax
Housing material	VA No. 1.4305
Active surface	PTFE (FDA 21 CFR 177.1550)

*Enclosure rating IEC 60529 for connector on request.

All specifications are subject to change without notice. (10/2011)

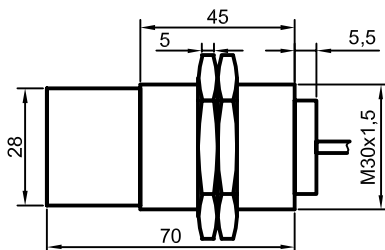

Made in Germany